

State of New Jersey Department of Transportation

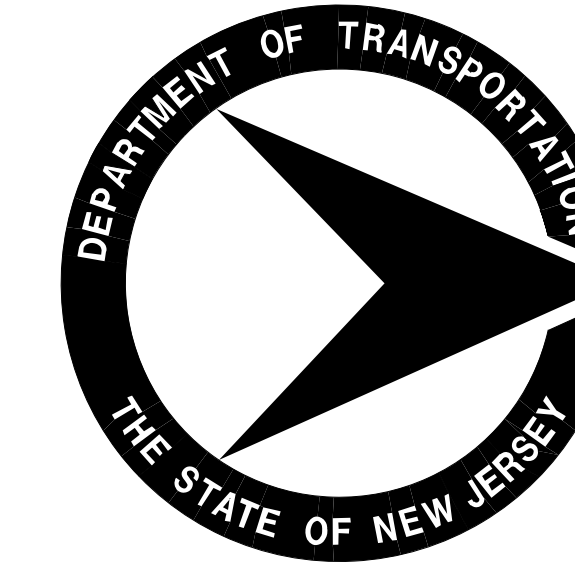

STATE	FEDERAL PROJECT NO.
N.J.	*

PLANS OF
ROUTE 23

BRIDGE OVER PEQUANNOCK RIVER / HAMBURG TURNPIKE

CONTRACT NO. 017083470

BRIDGE REPLACEMENT, DRAINAGE & UTILITIES

TOWNSHIP OF WEST MILFORD
BOROUGH OF KINNELON & BUTLER

PASSAIC COUNTY
MORRIS COUNTY

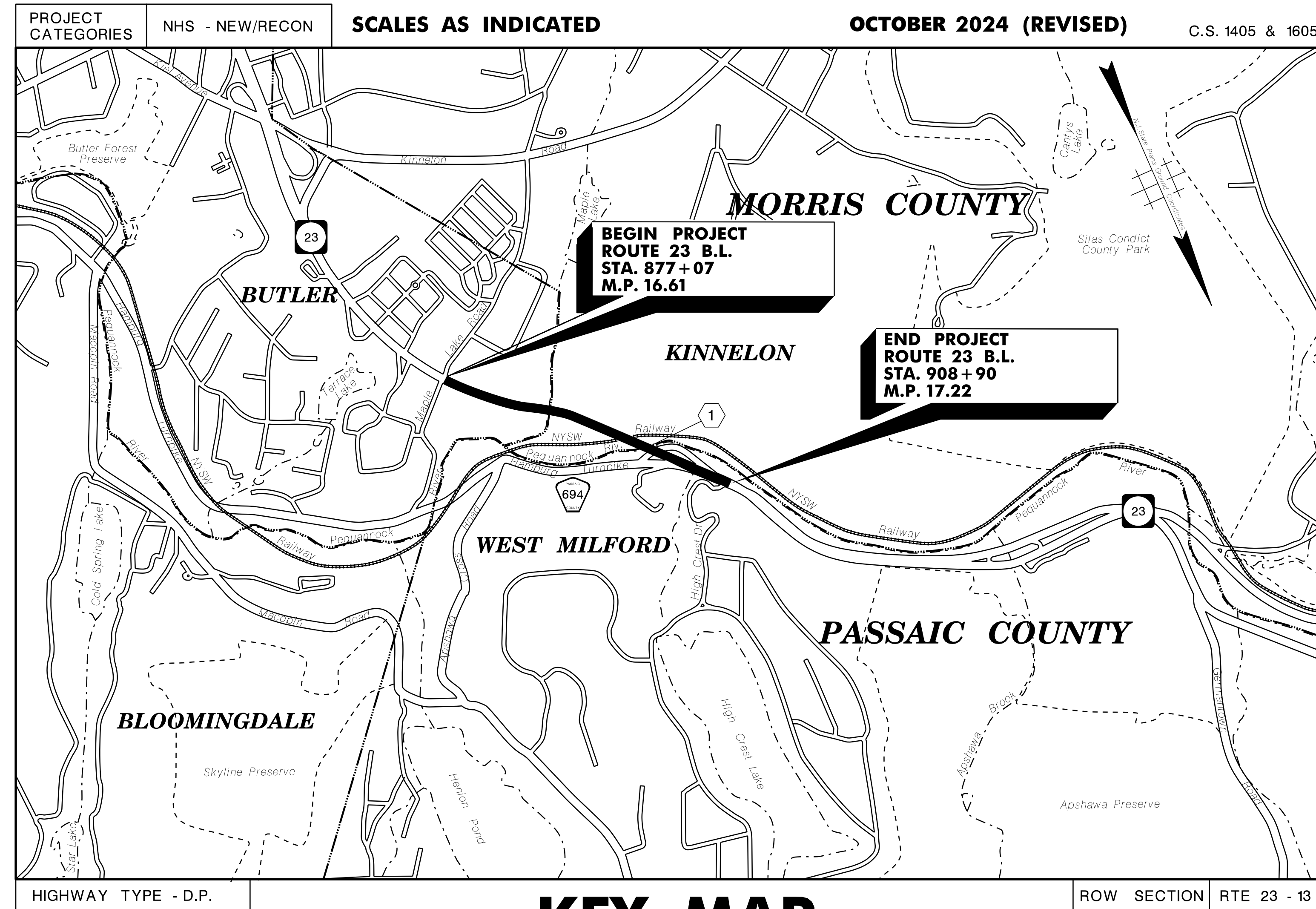

INDEX OF SHEETS	
SHEET NO.	DESCRIPTION
1	KEY
2	FRESHWATER WETLAND PERMIT PLANS

Wetland Impact Summary		
IMPACT AREAS	Original Disturbance	Additional Disturbance
Temporary Open Water Impact	10,656 SF (0.245 acres)	-
Permanent Open Water Impact	7,625 SF (0.175 acres)	-
Permanent Freshwater Wetland Area Impact	562 SF (0.013 acres)	-
Permanent Freshwater Wetland Transition Area Impact	28,940 SF (0.664 acres)	7,965 SF (0.183 acres)

NOTE:

PERMANENT FRESHWATER WETLAND TRANSITION IMPACT AREA (7,965 SF (0.183 Ac.)) TO BE RESTORED POST-CONSTRUCTION

VEGETATION TYPES (IMPACT AREAS)

- FORESTED (13,139 S.F. (0.302 ACRES))
- HERBACEOUS (18,019 S.F. (0.414 ACRES))
- NO VEGETATION GROWING BELOW EXISTING BRIDGE

FRESHWATER WETLAND PERMIT PLANS

OCTOBER 2024 (REVISED)

KEY MAP

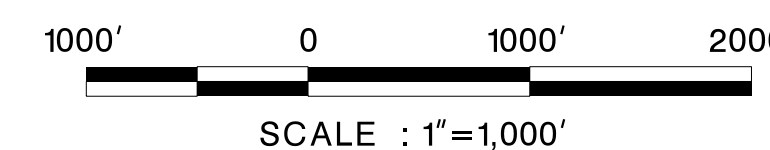

TOTAL LENGTH OF THE PROJECT = 3,221 LIN. FT. OR 0.61 MILES

TOTAL LENGTH OF FEDERAL PROJECT NO. * = 3,221 LIN. FT. OR 0.610 MILES

CHANGES MADE TO THESE PLANS SINCE SIGNATURE BY THE CONSULTANT MAY BE DETERMINED BY COMPARISON OF THE PLANS FILED AT THE DEPARTMENT WITH THOSE FILED AT THE OFFICE OF THE CONSULTANT.

MICHAEL BAKER INTERNATIONAL, INC.
CERTIFICATE OF AUTHORIZATION NO. 24GA27954700
DATE: 10/08/24
LORI A. WADE, P.E.
NEW JERSEY PROFESSIONAL ENGINEER LICENSE No. 24GE04953400

2019 STANDARD SPECIFICATIONS FOR ROAD AND BRIDGE CONSTRUCTION TO GOVERN



STATE	FEDERAL PROJECT NO.
N.J.	0023(332)

**TOWNSHIP OF WEST MILFORD
BOROUGH OF KINNELON**

**COUNTY OF PASSAIC
COUNTY OF MORRIS**

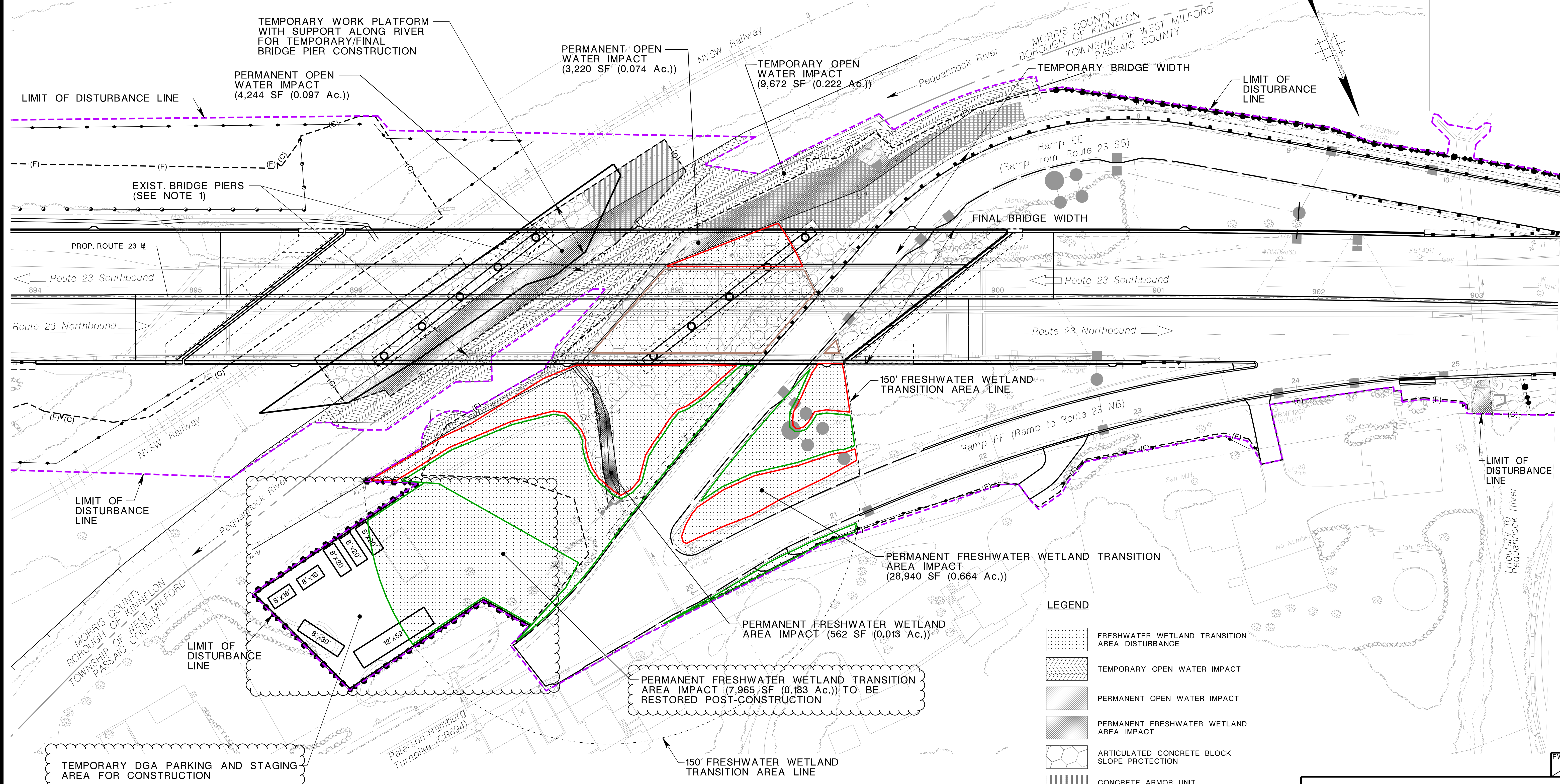

TEMPORARY DGA PARKING AND STAGING AREA FOR CONSTRUCTION

PERMANENT FRESHWATER WETLAND TRANSITION AREA IMPACT (7,965 SF (0.183 Ac.)) TO BE RESTORED POST-CONSTRUCTION

WETLAND IMPACT SUMMARY		
IMPACT AREAS	Original Disturbance	Additional Disturbance
Temporary Open Water Impact	9,672 SF (0.222 acres)	-
Permanent Open Water Impact	7,464 SF (0.171 acres)	-
Permanent Freshwater Wetland Area Impact	562 SF (0.013 acres)	-
Permanent Freshwater Wetland Transition Area Impact	28,940 SF (0.664 acres)	7,965 SF (0.183 acres) *

* REVISED PERMANENT FRESHWATER WETLAND TRANSITION AREA IMPACT TO BE RESTORED POST-CONSTRUCTION.

VEGETATION TYPES (IMPACT AREAS)

- FORESTED (9,860 S.F. (0.229 ACRES))
- HERBACEOUS (18,019 S.F. (0.414 ACRES))
- NO VEGETATION GROWING BELOW EXISTING BRIDGE

NOTES:

1. EXISTING BRIDGE PIER COLUMNS TO BE REMOVED TO STREAMBED ELEVATION.

LEGEND

- FRESHWATER WETLAND TRANSITION AREA DISTURBANCE
- TEMPORARY OPEN WATER IMPACT
- PERMANENT OPEN WATER IMPACT
- PERMANENT FRESHWATER WETLAND AREA IMPACT
- ARTICULATED CONCRETE BLOCK SLOPE PROTECTION
- CONCRETE ARMOR UNIT SLOPE PROTECTION
- RIP RAP STONE SLOPE PROTECTION
- - - LIMIT OF DISTURBANCE LINE
- WETLAND LINE
- SILT FENCE
- SILT FENCE (ORANGE)

NEW JERSEY DEPARTMENT OF TRANSPORTATION

FRESHWATER WETLAND PERMIT PLANS

ROUTE 23 BRIDGE OVER PEQUANNOCK RIVER / HAMBURG TURNPIKE
CONTRACT NO. 017083470

MICHAEL BAKER INTERNATIONAL, INC.
CERTIFICATE OF AUTHORIZATION NO. 24GA27954700
LORI A. WADE, P.E.
NEW JERSEY PROFESSIONAL ENGINEER LICENSE NO. 24GE04953400
DATE: 10/08/24

pen table=IP_PWP:dms24477\NIDOT-Baker_FWW_201651.pcn
scale=30.00000000:1.000000
date=3-OCT-2024 17:49
ID=Ronald.Mesk