

STATE	FEDERAL PROJECT NO.
N.J.	*

TOWNSHIP OF WEST MILFORD
BOROUGH OF KINNELON

COUNTY OF PASSAIC
COUNTY OF MORRIS

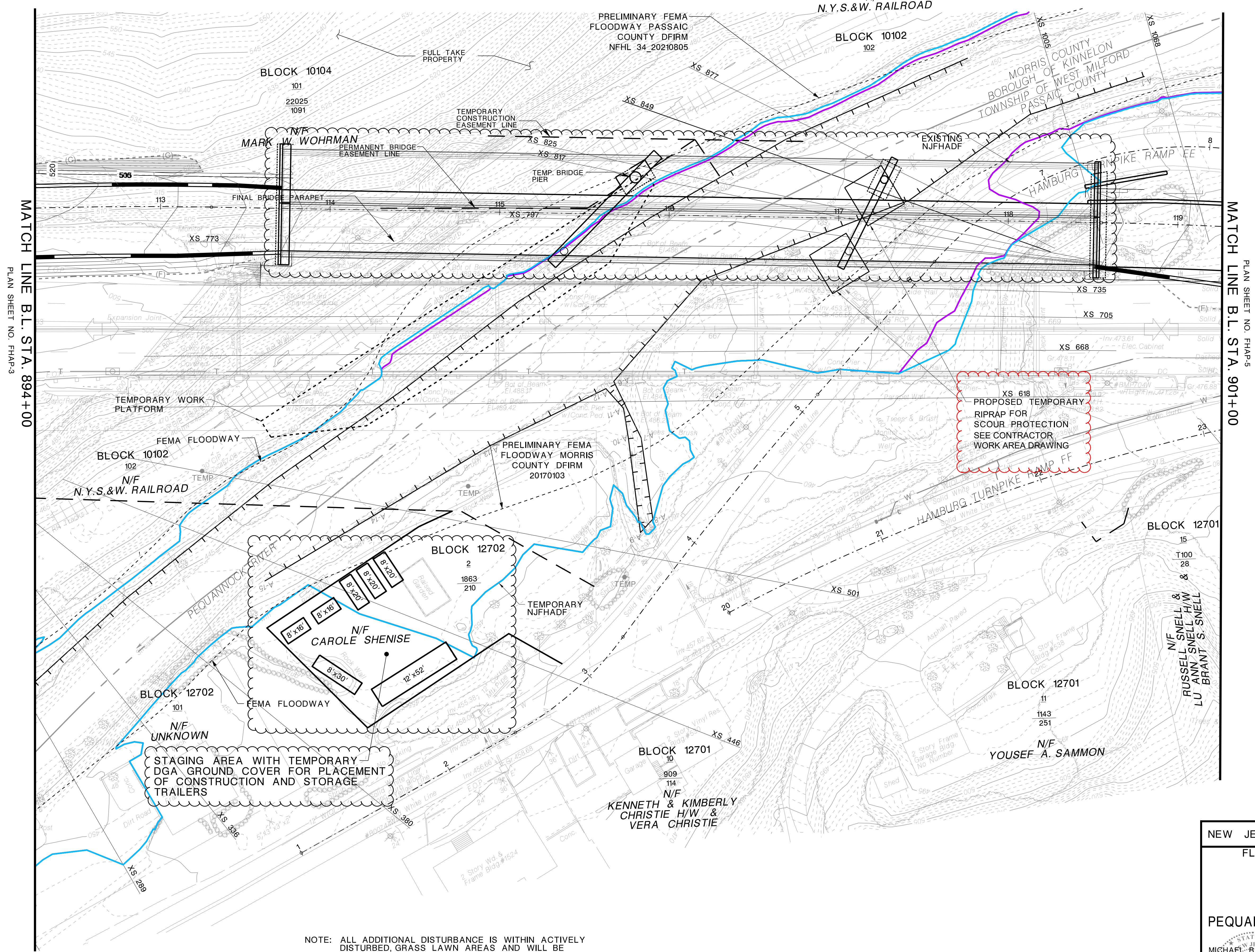
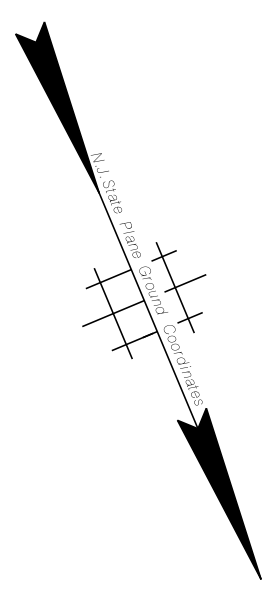
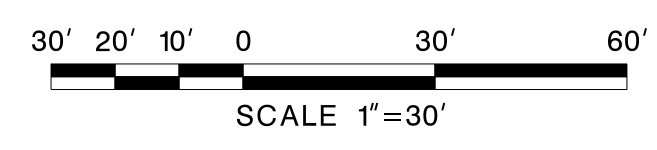

MATCH LINE B.L. STA. 894+00
PLAN SHEET NO. FHAP-3

MATCH LINE B.L. STA. 901+00
PLAN SHEET NO. FHAP-5

XS 618
PROPOSED TEMPORARY
RIPRAP FOR
SCOUR PROTECTION
SEE CONTRACTOR
WORK AREA DRAWING

STAGING AREA WITH TEMPORARY
DGA GROUND COVER FOR PLACEMENT
OF CONSTRUCTION AND STORAGE
TRAILERS

NOTE: ALL ADDITIONAL DISTURBANCE IS WITHIN ACTIVELY
DISTURBED GRASS LAWN AREAS AND WILL BE
RESEED POST-CONSTRUCTION.

NEW JERSEY DEPARTMENT OF TRANSPORTATION
FLOOD HAZARD AREA PERMIT PLANS
**FLOODPLAIN AND
FLOODWAY PLANS
(DIVERSIONARY ROADWAY)**
ROUTE 23, BRIDGE OVER
PEQUANNOCK RIVER / HAMBURG TURNPIKE
CONTRACT NO. 017083470

MICHAEL BAKER INTERNATIONAL, INC.
CERTIFICATE OF AUTHORIZATION NO. 24GA27954700
DATE: 10/08/24

LORI A. WADE, P.E.
NEW JERSEY PROFESSIONAL ENGINEER LICENSE NO. 24GE04953400

1 09/16/24 REVISED PER CONSTRUCTION STAGING
AND VALUE ENGINEERING

42
112

ID=Ronald.Meeh date=17-SEP-2024 16:52 scale=30.00000000:1.00000000 pen table=IP_PWP:dms2447\NIDOT-Baker_FHA_201651.pen

NJDOT Design Services

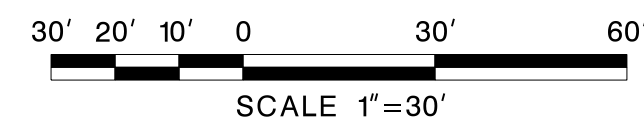

BOROUGH OF BUTLER

COUNTY OF MORRIS

STATE	FEDERAL PROJECT NO.
N.J.	*

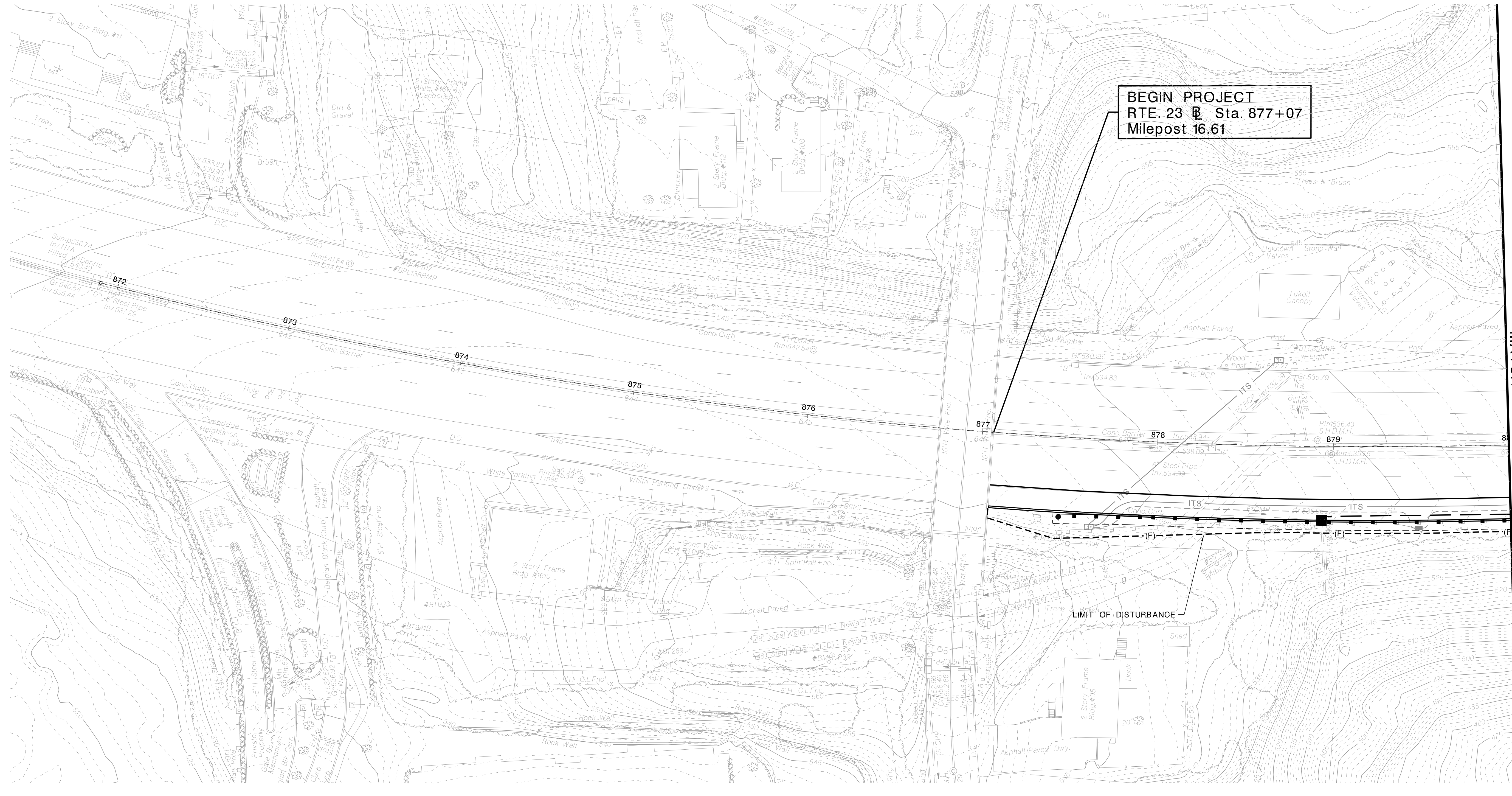

MATCH LINE B.L. STA. 880+00

PLAN SHEET NO. DGSER8

PROPOSED REGULATED ACTIVITY	NJAC 7-13 Subsection	PROJECT TOTAL		ALLOWABLE DISTURBANCE
		Original Disturbance	Additional Disturbance	300-foot Riparian Zone
Reconstructed Public Roadway-crossing a water *	(g)	107,223 SF	-	18,000 SF
Areas stabilized using other methods	(i)	4,842 SF	-	2,000 SF = 200 LF x 10 SF per linear foot of armoring
Outfall 1 (Stormwater Pipe)	(j)	318 SF	-	6,000 SF
Outfall 2 (Headwall and Outlet Protection)	(j)	1,837 SF	-	2,000 SF
Outfall 3 (Stormwater Pipe)	(j)	57 SF	-	6,000 SF
Outfall 4 (Headwall and Outlet Protection)	(j)	2,446 SF	-	2,000 SF
Outfall 4 (Stormwater Pipe)	(j)	2,250 SF	-	6,000 SF
Outfall 5 (Stormwater Pipe)	(j)	188 SF	-	6,000 SF
Total Area of Disturbance Permitted Any Regulated Activity not listed in Table 11.2	(y)	38,144 SF	13,220 SF	6,000 SF

*ALL OTHER IMPACTS ARE NOT HATCHED

NOTE: ALL ADDITIONAL DISTURBANCE IS WITHIN ACTIVELY DISTURBED GRASS LAWN AREAS AND WILL BE RESEEDDED POST-CONSTRUCTION.

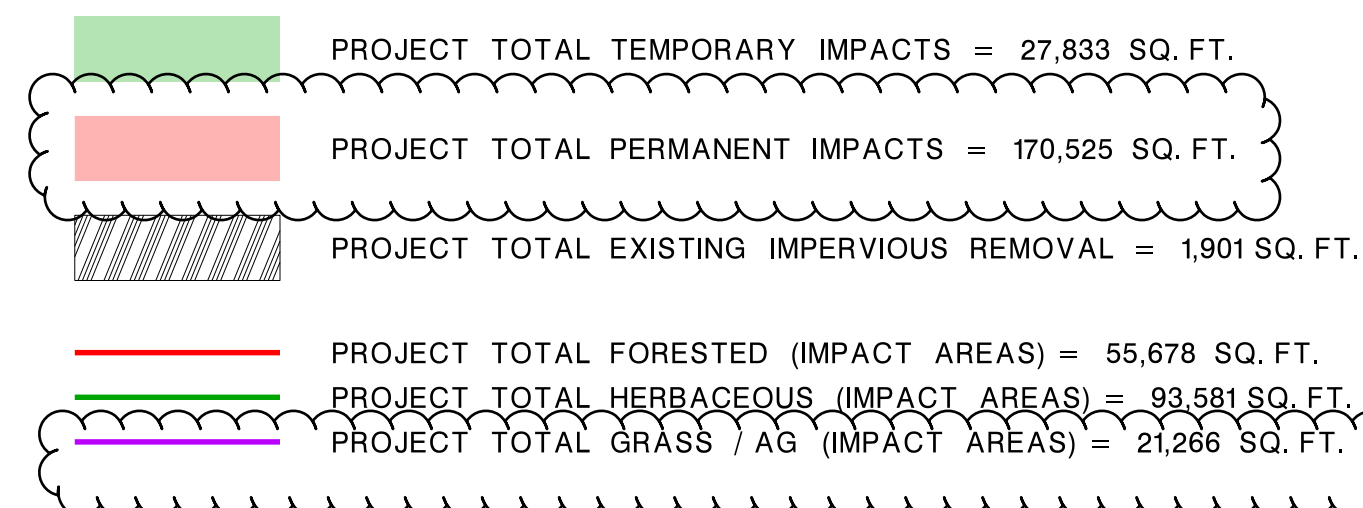

NEW JERSEY DEPARTMENT OF TRANSPORTATION
 FLOOD HAZARD AREA PERMIT PLANS
RIPARIAN ZONE IMPACT PLANS
 ROUTE 23, BRIDGE OVER PEQUANNOCK RIVER / HAMBURG TURNPIKE
 CONTRACT NO. 017083470
 MICHAEL BAKER INTERNATIONAL, INC.
 CERTIFICATE OF AUTHORIZATION NO. 24GA27954700
 DATE: 10/08/24
 LORI A. WADE, P.E.
 NEW JERSEY PROFESSIONAL ENGINEER LICENSE NO. 24GE04953400

RP-1
RP-6

1 09/16/24 REVISED PER CONSTRUCTION STAGING AND VALUE ENGINEERING

51
112

NJDOT Design Services

pen table=IP_PWP:dms2447\NJDOT-Baker_FHA_201651.pen
scale=30.000000001.000000
date=17-SEP-2024 20:00
ID=Ronald.Meek

TOWNSHIP OF WEST MILFORD
BOROUGH OF KINNELON

COUNTY OF PASSAIC
COUNTY OF MORRIS

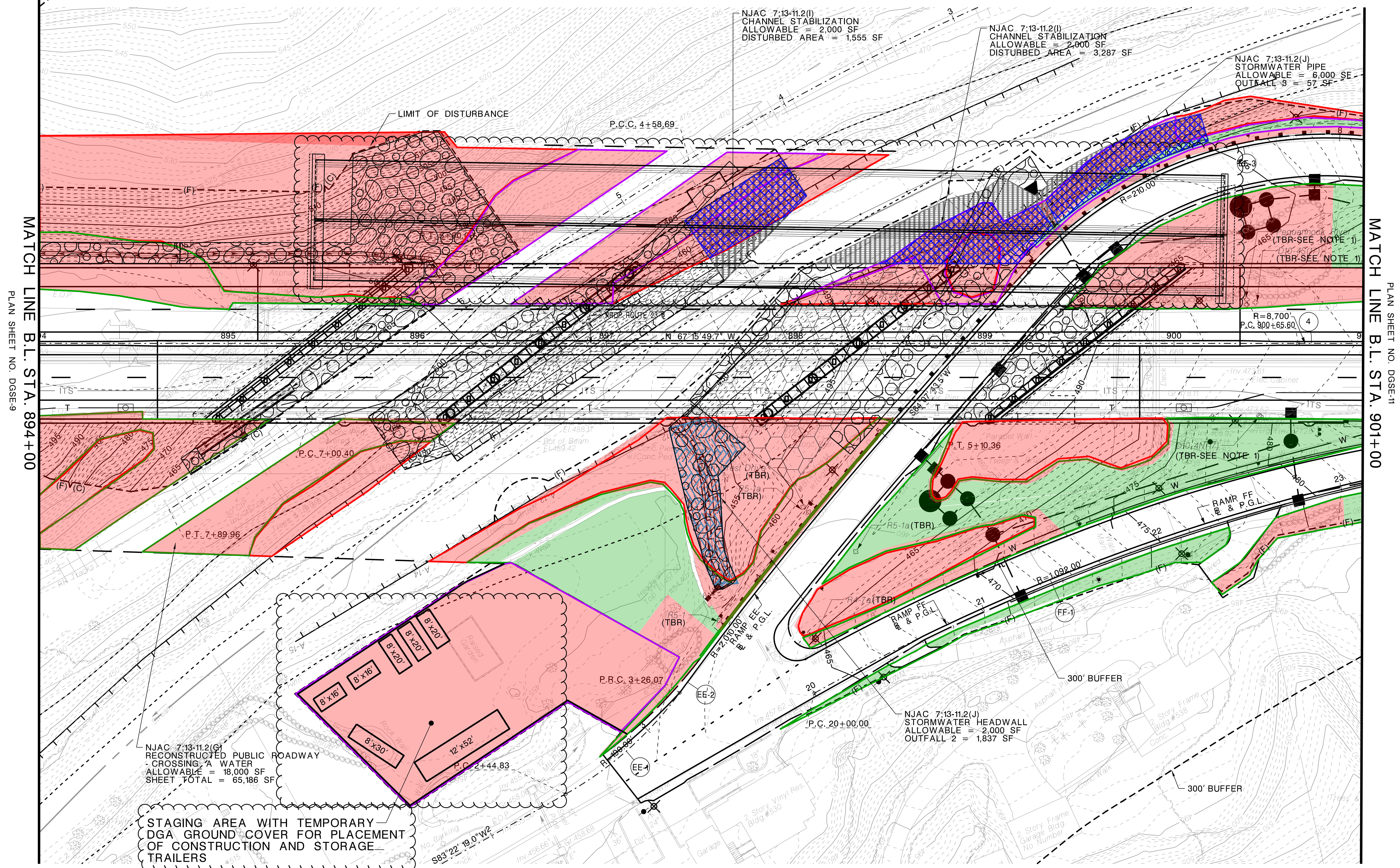
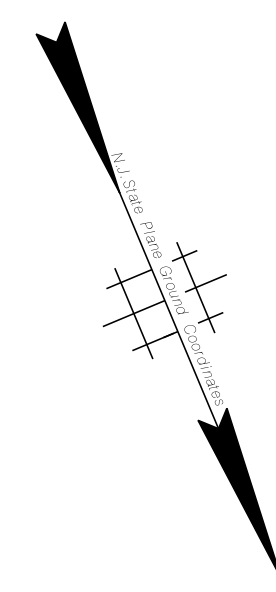
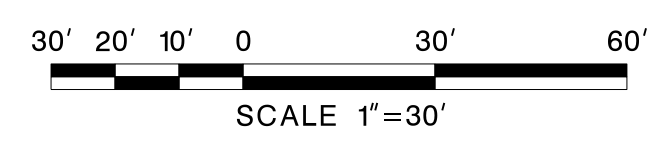

MATCH LINE B.L. STA. 894+00
PLAN SHEET NO. DGSE-9

MATCH LINE B.L. STA. 901+00
PLAN SHEET NO. DGSE-11

NOTE: ALL ADDITIONAL DISTURBANCE IS WITHIN ACTIVELY DISTURBED GRASS LAWN AREAS AND WILL BE RESEDED POST-CONSTRUCTION.

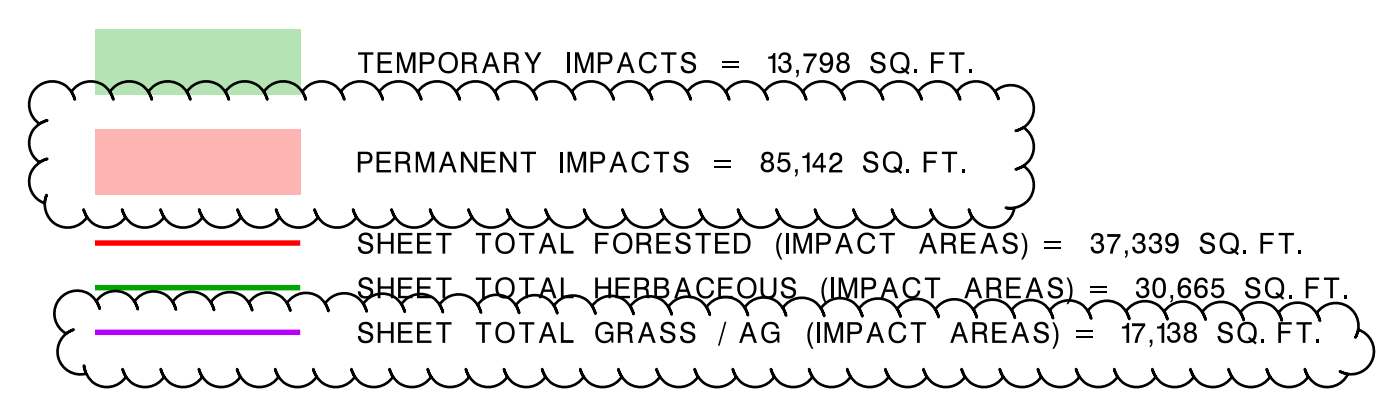

ALLOWABLE DISTURBANCE				
PROPOSED REGULATED ACTIVITY	NJAC 7-13 Subsection	Original Disturbance	Additional Disturbance	300-foot Riparian Zone
Reconstructed Public Roadway-crossing a water *	(g)	65,186 SF	-	18,000 SF
Areas stabilized using other methods	(i)	4,842 SF	-	2,000 SF = 200 LF x 10 SF per linear foot of armoring
Outfall 2 (Headwall and Outlet Protection)	(j)	1,837 SF	-	2,000 SF
Outfall 3 (Stormwater Pipe)	(j)	57 SF	-	6,000 SF
*ALL OTHER IMPACTS ARE NOT HATCHED				
Total Area of Disturbance Permitted Any Regulated Activity not listed in Table 11.2	(y)	-	13,220 SF	6,000 SF

NEW JERSEY DEPARTMENT OF TRANSPORTATION
FLOOD HAZARD AREA PERMIT PLANS

RIPARIAN ZONE IMPACT PLANS

ROUTE 23, BRIDGE OVER PEQUANNOCK RIVER / HAMBURG TURNPIKE
CONTRACT NO. 017083470

MICHAEL BAKER INTERNATIONAL, INC.
CERTIFICATE OF AUTHORIZATION NO. 24GA27954700
DATE: 10/08/24

LORI A. WADE, P.E.
NEW JERSEY PROFESSIONAL ENGINEER LICENSE NO. 24GE04953400

RP-4
RP-6

54
112

pen table=IP_PWP\dms2447\NIDOT-Baker_FHA_201651.pen
scale=30.00000000;1.000000
date=17-SEP-2024 20:06
ID=Ronald.Meeh

NJDOT Design Services

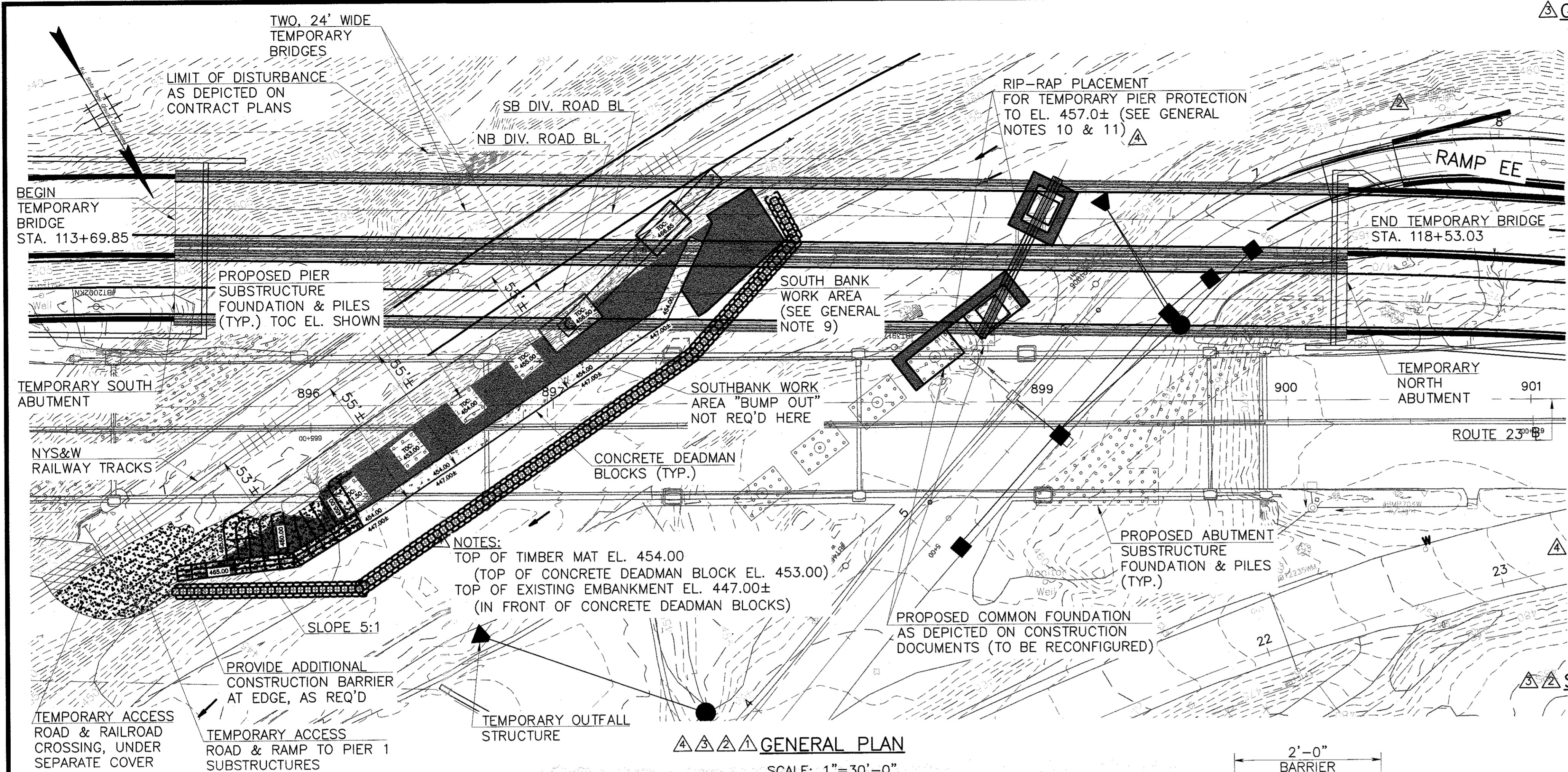

- GENERAL NOTES:**
1. ALL WORK SHALL BE IN ACCORDANCE WITH CURRENT AASHTO STANDARD SPECIFICATIONS FOR HIGHWAYS BRIDGES (WITH INTERIMS) AND AASHTO GUIDE SPECIFICATIONS FOR BRIDGE TEMPORARY WORKS.
 2. REFER TO CONTRACT DOCUMENTS AND SPECIAL PROVISIONS (SPECIFICATIONS) FOR REQUIREMENTS NOT SHOWN HEREON.
 3. THE CONTRACTOR IS REQUIRED TO COMPLY WITH ALL INDUSTRY STANDARD SAFETY PROCEDURES, OSHA PROVISIONS AND OTHER APPLICABLE SAFETY REQUIREMENTS.
 4. ALL TRAFFIC CONTROL SHALL BE IN ACCORDANCE WITH CONTRACT DOCUMENTS.
 5. IF THE ACTUAL FIELD CONDITIONS DIFFER SUBSTANTIALLY FROM THE DESIGN CRITERIA, THE CONTRACTOR SHALL CONTACT THE ENGINEER FOR INSTRUCTIONS.
 6. THE CONTRACTOR TO PROVIDE PUMPS WITH SUFFICIENT CAPACITY TO MAINTAIN A SUITABLE DRY WORKING AREA FOR FOOTING AND SUBSTRUCTURE CONSTRUCTION.
 7. THE CONTRACTOR SHALL LOCATE AND MARK-OUT ALL EXISTING UTILITIES PRIOR TO CONSTRUCTION.
 8. THE CONTRACTOR SHALL MAINTAIN A CLEAR DISTANCE TO OVERHEAD ELECTRIC LINES ACCORDING TO OSHA, OR THE GOVERNING CLEARANCE FROM THE HIGH VOLTAGE PROXIMITY ACT & ALL SAFETY REGULATIONS WHEN WORKING AROUND HIGH VOLTAGE LINES.
 9. THE CONTRACTOR HAS THE OPTION TO UTILIZE THE TEMPORARY ACCESS ROAD (UNDER SEPARATE COVER) IN LIEU OF THE SOUTH BANK WORK AREA DETAIL FOR TEMPORARY PIERS S1 AND S2.
 10. THE CONTRACTOR SHALL PLACE RIP-RAP TO EL. 457.0 MINIMUM AT SOUTH BANK AND NORTH BANK FOR TEMPORARY EROSION CONTROL. PIER PROTECTION FOR TEMPORARY BRIDGE TRUSS TOWERS FOR 100-YEAR FLOOD EVENT UP TO EL. 461.00 TO BE SUBMITTED UNDER SEPARATE COVER.
 11. RIP-RAP TO BE A MINIMUM OF D50 18" X 3' THICK WITH A MAXIMUM SLOPE OF 2:1. CONTRACTOR SHALL INSTALL GEO-TEXTILE BARRIER BETWEEN EXISTING GROUND LINE AND PROPOSED RIP-RAP. FOR FINAL CONDITIONS, ALL RIP-RAP TO BE COMPLETELY REMOVED AND GROUND LINE PREPARED, AS REQUIRED, FOR THE PLACEMENT OF THE ARTICULATED BLOCK AND A-JACKS, PER CONTRACT PLANS.
 12. FOR FINAL CONDITIONS, CONCRETE DEADMAN BLOCKS AND CRUSH STONE/ROCK AND FLOWABLE FILL TO BE COMPLETELY REMOVED AND GROUND LINE PREPARED, AS REQUIRED, FOR THE PLACEMENT OF THE ARTICULATED BLOCK, PER CONTRACT PLANS.
 13. TEMPORARY COFFERDAM SYSTEM AND NOTES, SUBMITTED UNDER SEPARATE COVER. TEMPORARY COFFERDAM SYSTEM LIMITS AND USE TO FOLLOW CONTRACT DOCUMENTS CONSTRUCTION DETAILS. AT NO TIME SHALL THE CONTRACTOR INSTALL BOTH SOUTH AND NORTH EMBANKMENT TEMPORARY COFFERDAMS SIMULTANEOUSLY. SEE SEPARATE SUBMITTAL FOR ALL LIMITS AND NOTES.

- STRUCTURAL NOTES:**
1. CONCRETE DEADMAN BLOCKS SHALL HAVE A MINIMUM COMPRESSIVE STRENGTH OF 3,000 PSI AT 28 DAYS, UNLESS OTHERWISE NOTED.
 2. TIMBER SHALL BE MIXED OAK No. 1 WITH THE MINIMUM UNADJUSTED DESIGN VALUES OR GREATER: $F_b = 1,150$ PSI; $F_v = 155$ PSI; $F_c = 600$ PSI.
 3. TYPICAL SOUTH BANK WORK AREA TO BE FILLED WITH COMPACTED CRUSHED ROCK/STONE/FILL.
 4. RAMP SECTION OF SOUTH BANK WORK AREA TO BE FILLED WITH CONTROLLED LOW-STRENGTH MATERIAL (CLSM) / FLOWABLE FILL AT A MAXIMUM 2' LIFTS.
 5. CONTROLLED LOW-STRENGTH MATERIAL (CLSM) / FLOWABLE FILL SHALL BE UNIT WEIGHT CONCRETE = 35 TO 45 PCF MINIMUM COMPRESSIVE STRENGTH = 400 PSI
 6. TIE-RODS/BEARING PLATES/WASHER/NUTS TO BE WILLIAMSFORM GRADE 60 THREADED REBAR, EQUAL OR BETTER. ALL STEEL TIE CHANNELS TO BE ASTM A36 GRADE 36 OR EQUAL.

GENERAL PLAN
SCALE: 1"=30'-0"

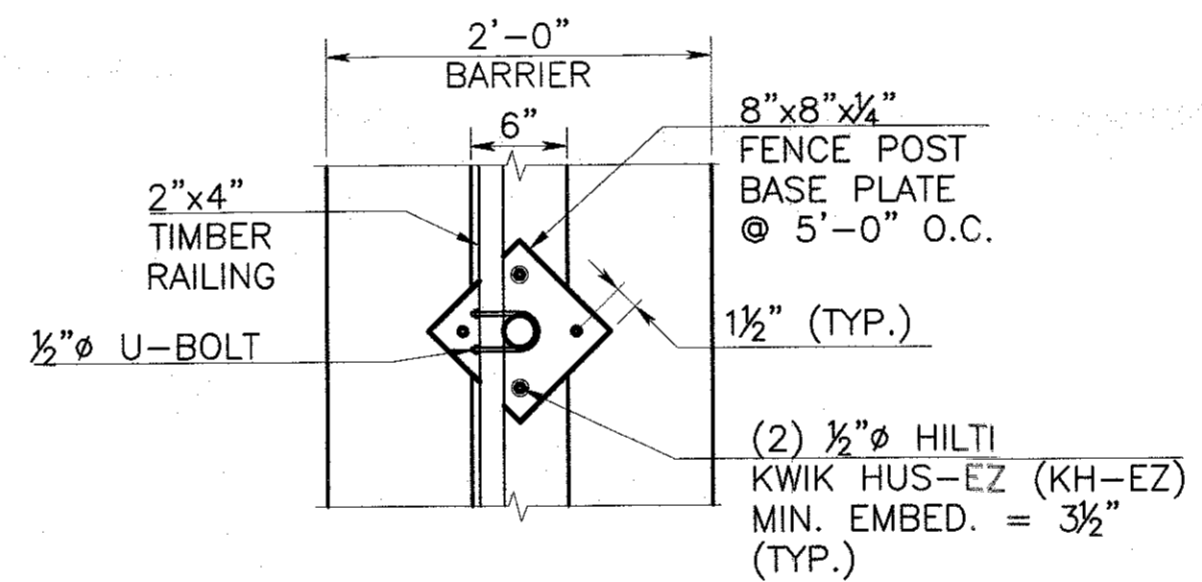

BARRIER RAILING DETAIL
SCALE: 1"=1'-0"

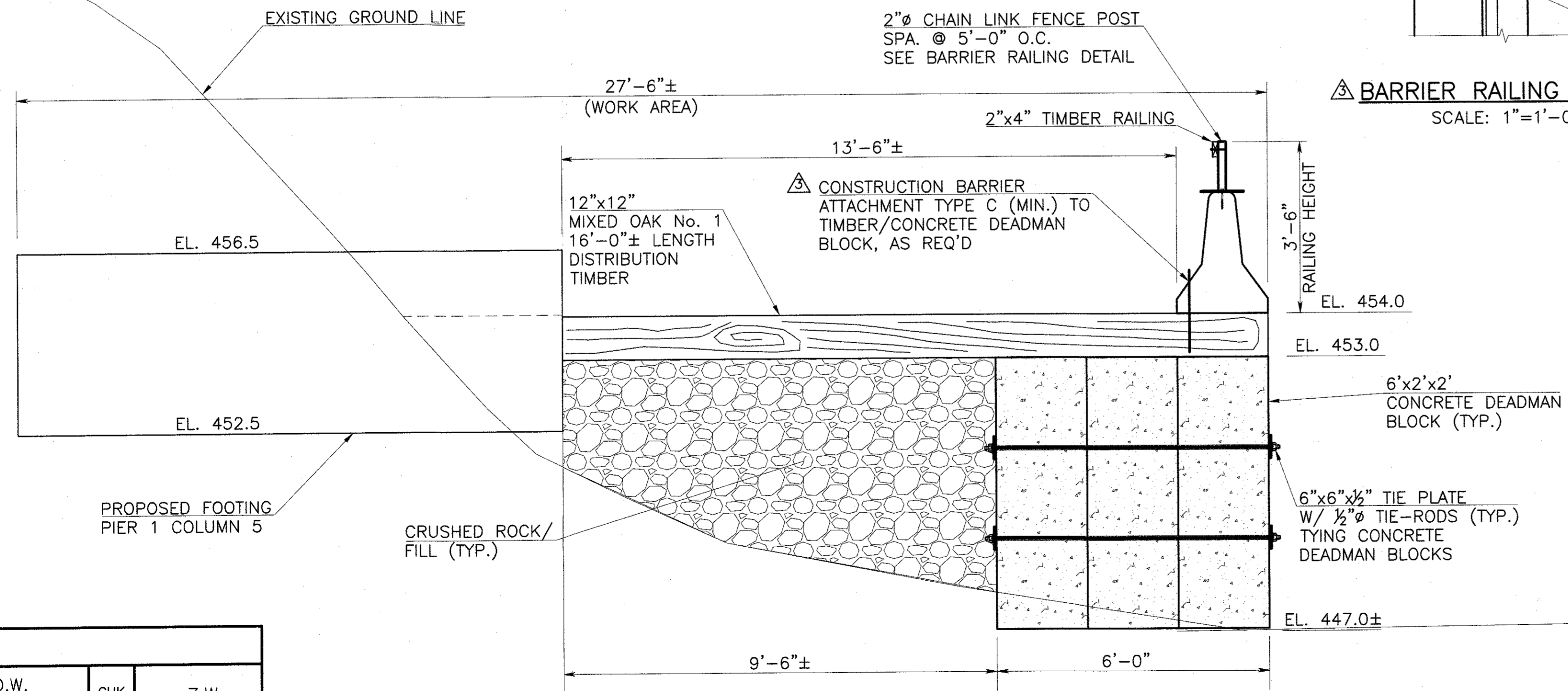

SOUTH BANK WORK AREA TYPICAL SECTION
SCALE: 1/2"=1'-0"
(PIER 1 COLUMN 5 FOOTING SHOWN, ALL OTHER COLUMN FOOTINGS SIMILAR)

CONTROL SECTION			
DES. BY	D.W.	CHK. BY	Z.W.
DWN. BY	D.M.		
IN CHARGE OF			Z.W.

NJDOT APPROVAL
APPROVED
AUG 05 2024
Deputy State Transportation Engineer

<p>DESIGNER RECOMMENDATION FOR APPROVAL</p> <p>JACOBS ENGINEERING GROUP, INC.</p> <p>THE DESIGNER, ACCORDING TO NJDOT STANDARD SPECIFICATIONS, HAS REVIEWED THIS DRAWING, WHICH THE CONTRACTOR DEVELOPED AS THE FINAL DESIGN OF CONCEPTUAL PLANS PRESENTED IN THE CONTRACT DOCUMENTS, FOR GENERAL CONFORMANCE WITH NJDOT DESIGN STANDARDS AND HEREBY RECOMMENDS APPROVAL TO THE ENGINEER.</p> <p>RECOMMENDED FOR APPROVAL DATE: 7/9/24</p> <p>SIGNATURE: [Signature]</p> <p>THIS DOES NOT RELIEVE THE CONTRACTOR FROM COMPLIANCE WITH REQUIREMENTS OF THE CONTRACT DOCUMENTS.</p>	<p>CONTRACTOR APPROVAL STAMP & SIGNATURE</p> <p>SHOP DRAWING REVIEW</p> <p>RITACCO CONSTRUCTION, INC.</p> <p>No Exceptions Taken Make Corrections Noted Amend and Resubmit Rejected - See Remarks Reviewed by: [Signature] Date: 08-07-24</p>
---	---

NEW JERSEY DEPARTMENT OF TRANSPORTATION

TEMPORARY SOUTH BANK WORK AREA & DETAILS 1

ROUTE 23 OVER PEQUANNOCK RIVER/HAMBURG TURNPIKE

CONTRACT NO. 017083470

CONTRACTOR: RITACCO CONSTRUCTION, INC.

PER COMMENTS	Z.W.	D.W.	5/20/24
PER COMMENTS	Z.W.	D.W.	5/17/24
PER COMMENTS	Z.W.	D.W.	5/9/24
PER COMMENTS	Z.W.	D.W.	4/3/24
REVISION	BY	CK'D	DATE

EIC GROUP LLC
CERTIFICATE OF AUTHORIZATION NO. 24048907900

ZHUO WEN WU
N.J. P.E. LICENSE #53188

DATE: 2/14/2024
SCALE: AS SHOWN
SHEET NO: 1 OF 2

PER COMMENTS	Z.W.	D.W.	5/20/24
PER COMMENTS	Z.W.	D.W.	5/17/24
PER COMMENTS	Z.W.	D.W.	5/9/24
PER COMMENTS	Z.W.	D.W.	4/3/24
REVISION	BY	CK'D	DATE